

EURO PLUS - EMF 26

12V-26AH - AGM MONOBLOCK VRLA BATTERY

Applications:

- UPS
- Data Centers
- Emergency Lighting
- Security Systems
- Medical Instruments

Features:

- Suitable for High Rate Discharge
- Self Regulating pressure valve
- Flame retardant ABS/PP case
- Product Performance Complies with JIS 8702 C
- Design life 8 Years

Cells Per Unit	6
Voltage Per Unit	12
Capacity	26Ah @ C ₂₀ upto 1.75ECV @27°C
Weight	8 Kgs
Maximum Discharge Current(1 min 1.60 ECV)	78AMP
Operating Temperature Range	-5°C~+40°C
Nominal Operating Temperature	27°C
Float Charging Voltage	13.5 to 13.8 V
Recommended Maximum Charging Current Limit	6.5AMP
Equalization and Cycle Service	14.2 to 14.8 V
Self Discharge	Batteries can be stored for more than 6 months @ 27°C Please charge batteries before using. For higher temperatures the time interval will be shorter
Construction	Plate Type: Flat Pasted Seperator: AGM Electrolyte: Immobilised H ₂ SO ₄
Terminal	F3
Container & Cover Material	ABS

Dimensions :	Length ± 5 mm	Width ± 5 mm	Height ± 5 mm
Battery	177	168	126

■ F3 Terminal

Unit: mm [inches]

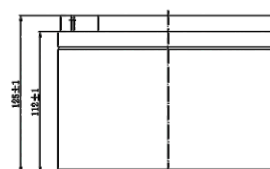
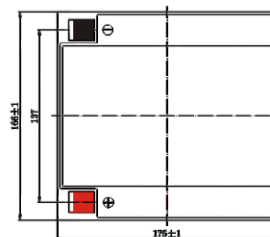
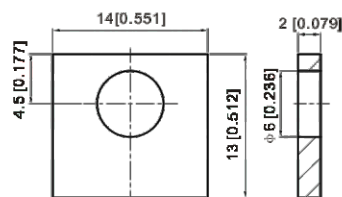

Constant Current Discharge Characteristics : Amps (27°C)

FV	5mins	10mins	15mins	20mins	30mins	45mins	1hr	2hr	3hr	4hr	5hr	6hr	8hr	10hr	20hr
1.85V/cell	49.5	38.0	31.5	27.2	21.1	15.5	13.1	7.73	6.05	4.92	4.01	3.48	2.81	2.35	1.29
1.80V/cell	66.5	48.6	38.1	32.2	24.8	18.0	14.6	8.44	6.51	5.25	4.31	3.73	2.98	2.42	1.30
1.75V/cell	74.9	53.4	41.6	34.6	25.8	18.7	15.3	8.75	6.63	5.37	4.42	3.84	3.03	2.48	1.31
1.70V/cell	82.5	58.2	44.4	36.4	26.8	19.5	15.8	8.97	6.81	5.51	4.53	3.92	3.07	2.53	1.34
1.65V/cell	91.0	62.8	47.2	38.7	28.3	20.0	16.2	9.10	7.11	5.70	4.66	4.00	3.12	2.58	1.35
1.60V/cell	100.4	68.2	50.5	41.2	29.9	20.8	16.3	9.49	7.32	5.88	4.81	4.09	3.15	2.61	1.36

Constant Current Discharge Characteristics : Watts (27°C)

FV	5mins	10mins	15mins	20mins	30mins	45mins	1hr	2hr	3hr	4hr	5hr	6hr	8hr	10hr	20hr
1.85V/cell	90.5	70.2	58.8	51.3	40.1	29.8	25.2	15.0	11.8	9.62	7.87	6.84	5.54	4.64	2.55
1.80V/cell	120.2	88.7	70.1	59.8	46.6	34.4	28.1	16.3	12.6	10.2	8.40	7.31	5.86	4.78	2.57
1.75V/cell	132.7	95.9	75.6	63.7	48.0	35.4	29.3	16.8	12.8	10.4	8.60	7.49	5.95	4.90	2.59
1.70V/cell	142.0	102.1	79.6	66.4	49.7	36.6	30.1	17.2	13.1	10.7	8.80	7.63	6.03	4.99	2.64
1.65V/cell	154.4	109.2	84.0	70.1	52.0	37.2	30.6	17.4	13.6	11.0	9.01	7.77	6.11	5.09	2.67
1.60V/cell	166.4	115.9	88.3	73.8	54.5	38.6	30.7	18.0	14.0	11.3	9.27	7.92	6.15	5.14	2.68

EURO PLUS - EMF 26

12V-26AH - AGM MONOBLOCK VRLA BATTERY

PERFORMANCE CHARACTERISTICS

DISCHARGE CHARACTERISTICS

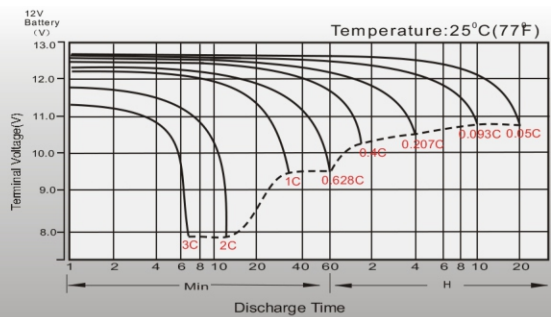

FLOAT CHARGING CHARACTERISTICS

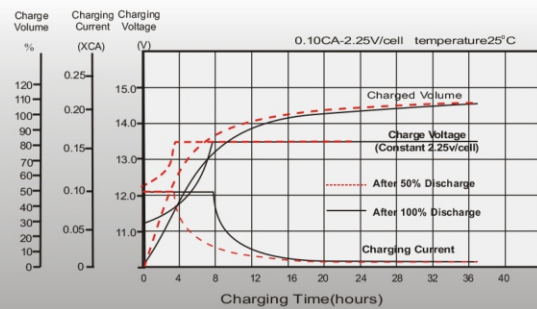

TEMPERATURE EFFECTS IN RELATION TO BATTERY CAPACITY

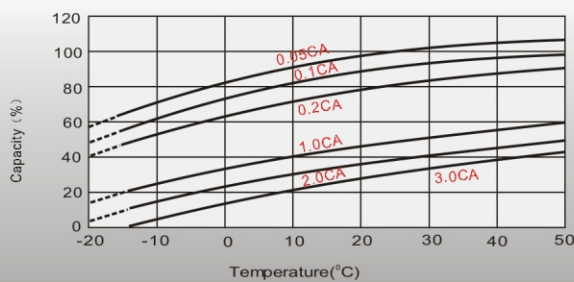

TEMPERATURE EFFECTS ON LONG TERM FLOAT LIFE

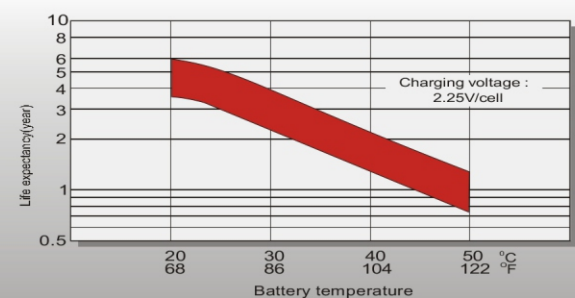

CYCLE LIFE IN RELATION TO DEPTH OF DISCHARGE

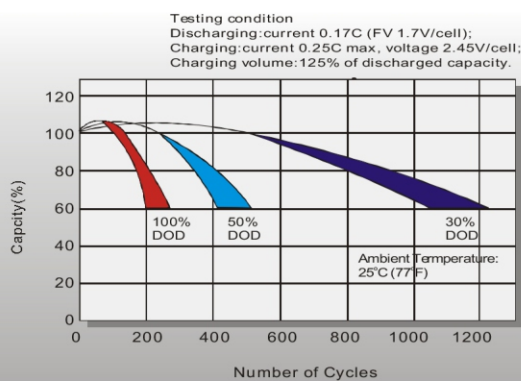

SELF DISCHARGE CHARACTERISTICS

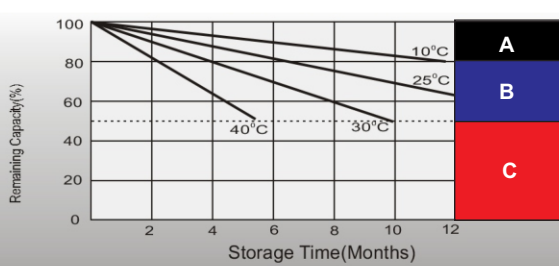

- A** No supplementary charge required
(Carry out supplementary charge before use if 100% capacity is required.)
- B** Supplementary charge required before use. Optional charging way as below:
1. Charged for above 3 days at limited current 0.25CA and constant voltage 2.25V/cell.
2. Charged for above 20 hours at limited current 0.25CA and constant voltage 2.45V/cell.
3. Charged for 8-10 hours at limited current 0.05CA.
- C** Supplementary charge may often fail to recover the capacity.
The battery should never be left standing till this is reached.